

## HIGHLIGHTS

- 1,882 sq. ft.
- 2 Lg. Modular Classrooms
- Opt. Restrooms
- Closets and more

## LARGE CLASSROOM FLOOR PLAN/DOUBLEWIDE

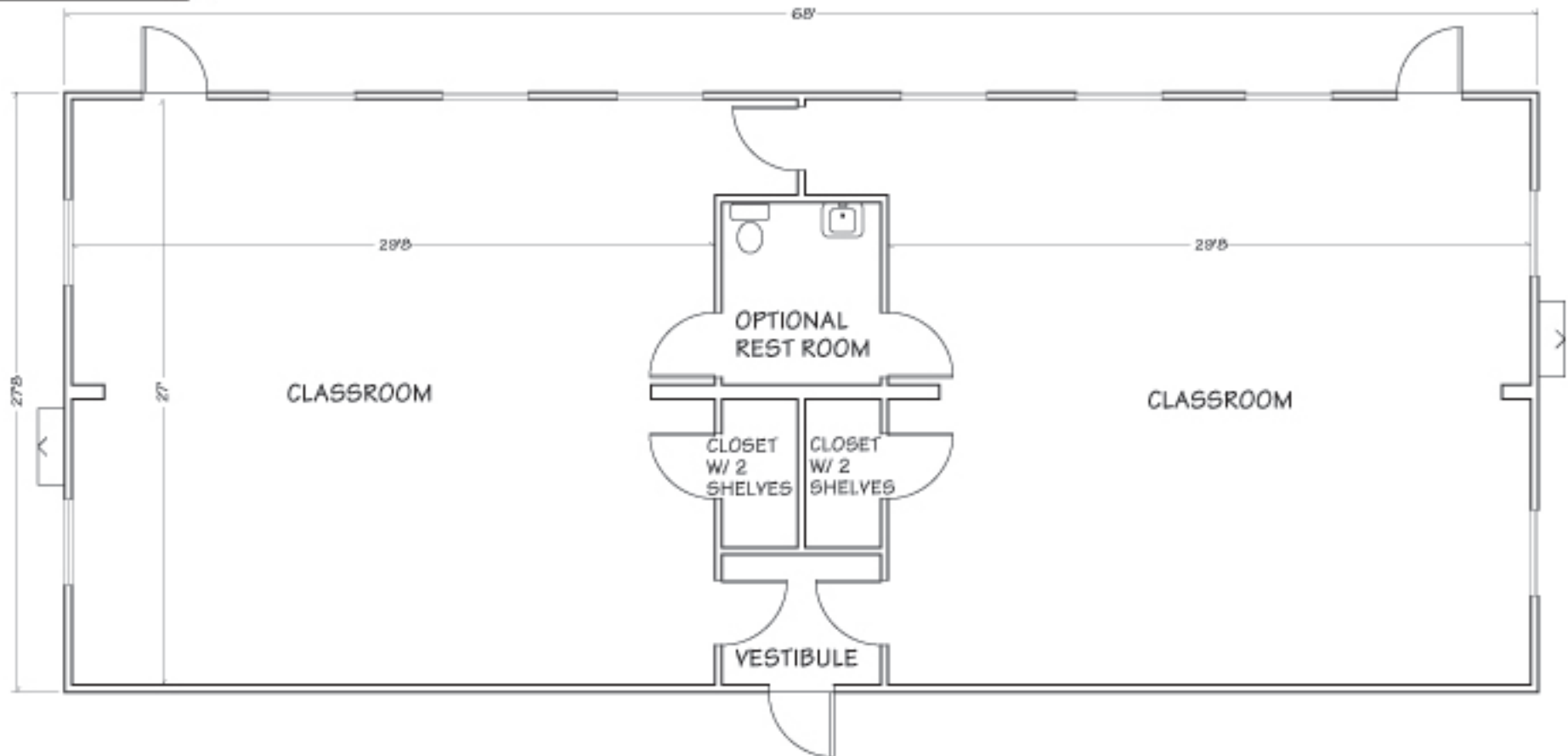

**SCHIAVI**  
LEASING CORPORATION

Corporate Headquarters  
102 Industrial Drive • Oxford, ME 04270  
877-548-8714 • [www.schiavileasingcorp.com](http://www.schiavileasingcorp.com)

OTHER SIZES AND  
FLOOR PLANS  
AVAILABLE

### GENERAL SPECIFICATIONS

- Meet or exceed local building codes
- Suitable for temporary or permanent use
- Customize this building to meet your space requirements